

ATTENTION
BEFORE BEGINNING THE INSTALLATION OF YOUR NEW GRILL,
ENSURE THAT THE KIT YOU HAVE RECEIVED MATCHES YOUR
TRUCK MODEL

**PLEASE READ THE INSTRUCTIONS
COMPLETELY BEFORE INSTALLING**

INSTALLATION INSTRUCTIONS

- A** - ARRANGE THE GRILL BARS AND SURROUND PIECES ON A FLAT SURFACE. THE PART NUMBERS FOR THE SURROUND ARE ETCHED ON THE PARTS AND SHOULD BE ARRANGED AS FOLLOWS: CL7123023-U04 IS DRIVER AND PASSENGER SIDE, CL7123023-U02 IS THE BOTTOM, CL7123023-U03 IS THE TOP AND CL7123023-U01 IS THE LOUVERS STYLE BARS.
- B** - HOLD THE PIECES OF THE GRILL SURROUND UP TO YOUR FACTORY GRILL TO ENSURE THAT THE HOLES ON THE SURROUND LINE UP WITH THE EXISTING RIVETS AROUND YOUR GRILL.
- C** - REMOVE THE FACTORY GRILL SCREEN BY CAREFULLY DRILLING OR GRINDING THE RIVETS THAT HOLD ON THE 2 PIECE FACTORY ALUMINIUM OUTER TRIM. DO NOT DAMAGE THE FACTORY ALUMINIUM OUTER TRIM, IT WILL BE REINSTALLED LATER. REMOVE THE FACTORY **GRILL** THAT WAS SECURED BY THE 2 PIECE FACTORY ALUMINIUM OUTER TRIM, THIS PART WILL BE REPLACED BY THE 4 PIECE GRILL SURROUND.
- D** - PEEL THE PVC FROM THE 4 PIECE GRILL SURROUND.
- E** - USE THE 1"LG CARRIAGE BOLTS, FLAT WASHERS, AND LOCK NUTS TO INSTALL THE GRILL SURROUND UNDER THE 2 PIECE FACTORY ALUMINIUM OUTER TRIM AS ILLUSTRATED AND INSTALL IT ON THE TRUCK.
- F** - ATTACH THE LOUVERS STYLE BARS TO THE TABS ON THE GRILL SURROUND AS ILLUSTRATED USING THE 1/2"LG CARRIAGE BOLTS. IT IS ADVISED TO PEEL THE PVC AWAY FROM THE BOLT HOLES ON THE LOUVERS STYLE BARS.
- G** - INSTALL THE TOP AND BOTTOM LOUVERS STYLE BARS, THEN WORK FROM THE TOP DOWN (IT MAY BE NECESSARY TO LOWER THE HOOD TO TIGHTEN THE BOLTS ON THE BOTTOM LOUVERS STYLE BARS).
- H** - PEEL THE REMAINING PVC FROM LOUVERS STYLE BARS.
- I** - TIGHTEN ALL BOLTS AND SCREWS FIRMLY.

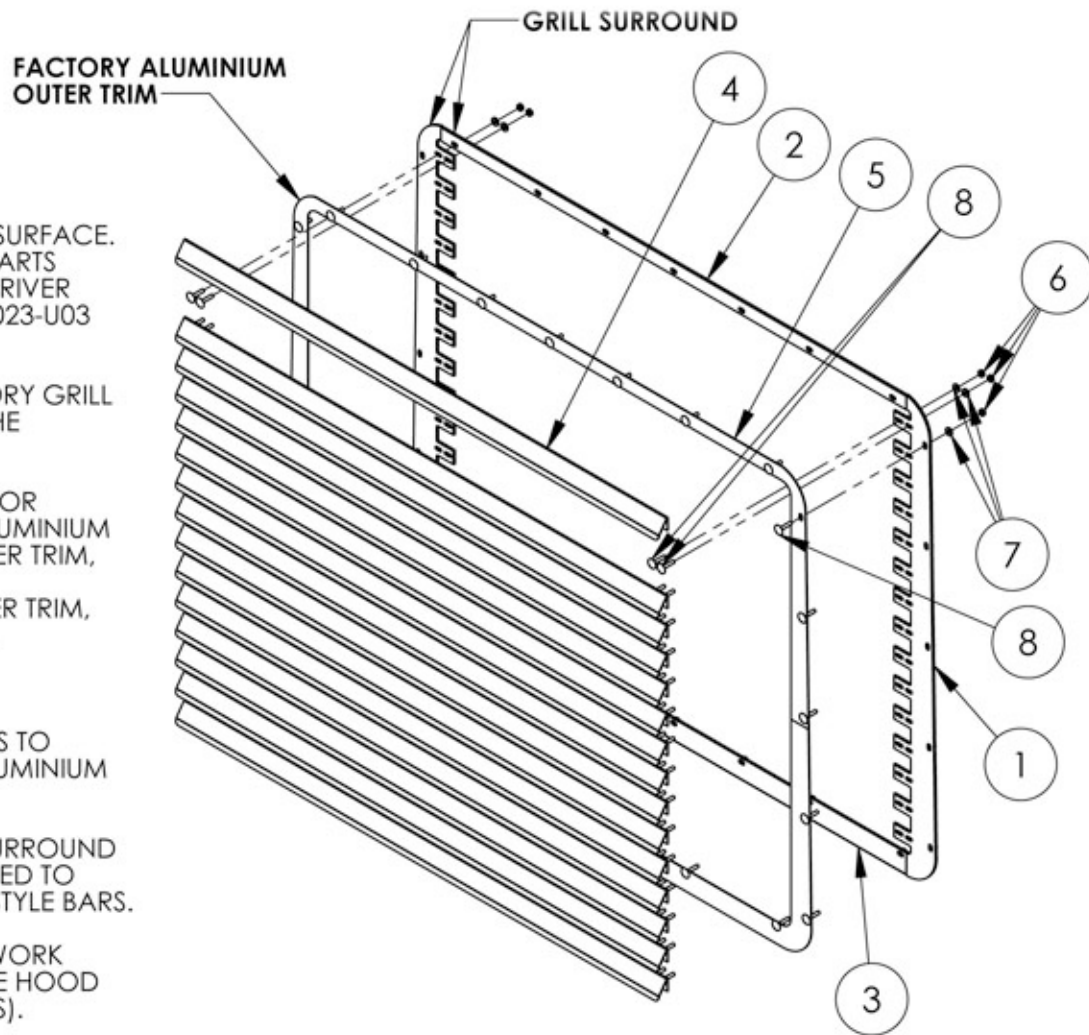

TRUX ACCESSORIES			
TITLE: PETERBILT REPLACEMENT GRILLS 359, 379 EXTENDED & REGULAR HOOD GRILLS			
SIZE	DWG. NO.	TP-1001	
DRAWN BY	NAME	DATE	REV
P.W.		20-11-2008	PH1
SCALE: 1:11	WEIGHT: LBS	SHEET: 1 OF 1	

ITEM NO.	PART NUMBER	DESCRIPTION	QTY
1	CL7123023-U04	GRILL SURROUND DRIVER & PASSENGER SIDE	2
2	CL7123023-U03	GRILL SURROUND BOTTOM	1
3	CL7123023-U02	GRILL SURROUND TOP	1
4	CL7123023-U01	LOUVER STYLE BARS	15
5	-	FACTORY ALUMINIUM OUTER TRIM	1
6	-	HEX. NYLOCK NUT #10-32	84
7	-	FLAT WASHER ID#10 X OD 1/2" SS	84
8	-	CARRIAGE BOLT #10-32 X 1"LG	84