

## VK 135004

### **KENWORTH 1999-2004 Split-Flat Windshield -Wicked DROPPED SUN VISOR INSTRUCTIONS**

**Read Entire Instruction Sheet before Beginning**

#### **Steps:**

1. Unpack the carton and make sure all parts are in the box.
2. Remove your current visor:
  - a. Note: You will need to reuse the bolts which go into the cab of the truck.
3. Grind off the heads of the Huck bolts
  - a. Hold the existing brackets in place and take your time carefully grinding the huck bolt heads off. If you grind too fast or too hard you will damage the paint around the head. It is recommended that you grind a little bit at a time.
4. Mount center bracket. With one person holding the bracket on the outside and one person installing the inner support plates and hand tighten the nuts.
5. Install side visor with one bolt in the end of the cab and one bolt through the center bracket.
6. Mount the outer bracket through the center holes in the visor and align outer bracket.
  - a. Now with the visor aligned mark the holes in the outer mounting bracket and extra hole at the end of each side of the visor using this as a template.
7. Remove the visor
8. Center punch where the holes are to be drilled.
  - a. Drill center mounting bracket holes with a 1/4" drill bit.
9. Install outer mounting bracket
10. Install fastener in cab with assembly supplied.
11. Install visor (step 5) and all remaining bolts and align.
12. Remove pvc coating and tighten all bolts and screws. We recommend loctite or silicone to prevent loosening from over the road use.

\*Mounting brackets are two piece (6 pieces) for the installation of visor.



# KENWORTH - Wicked Drop Visor 2pc Boltless W900 Split Flat W/S 1999-2004 INSTALLATION INSTRUCTIONS

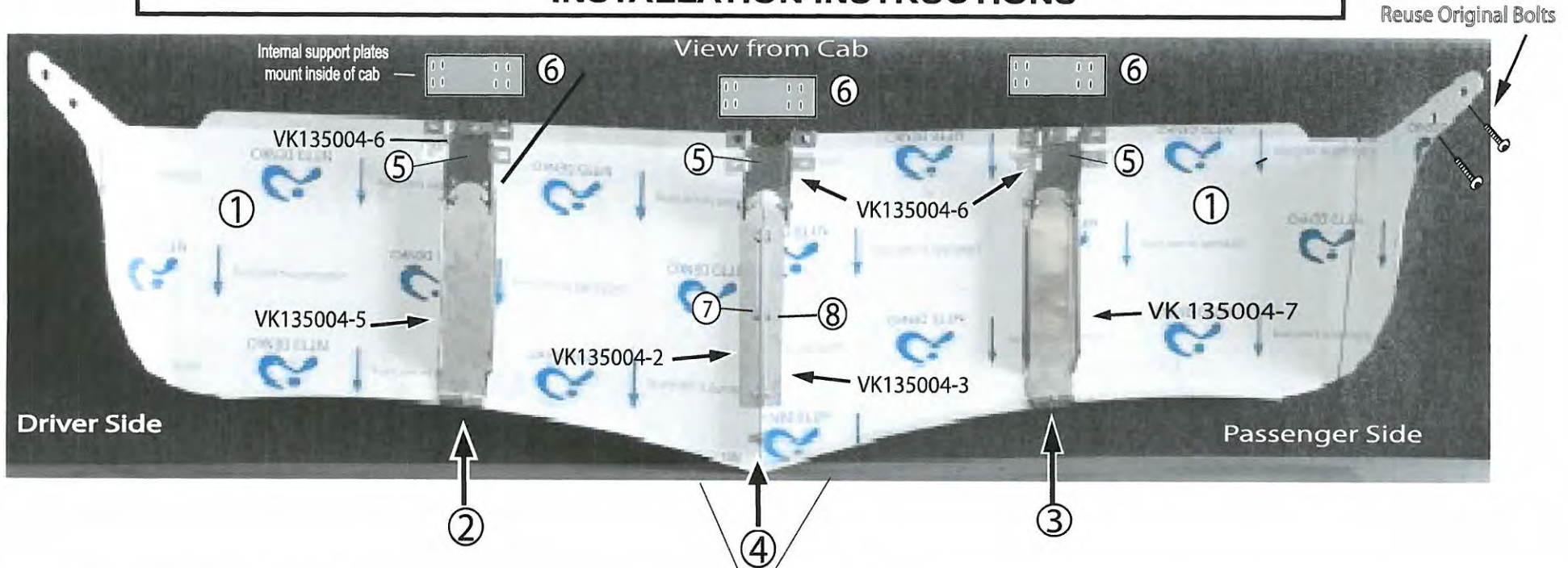

Small Brkt bolts to visor mntd brkt.

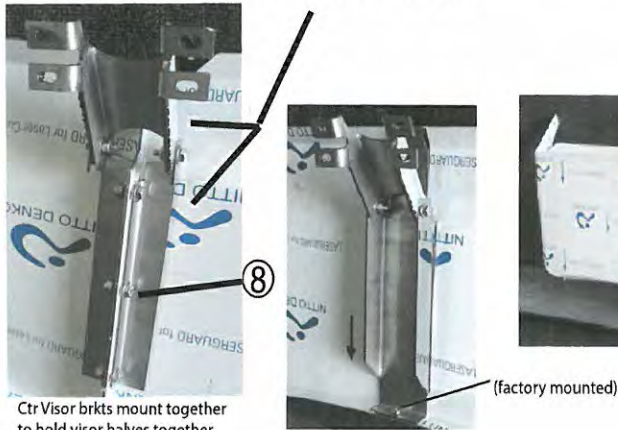

Ctr Visor brkts mount together to hold visor halves together.

VISOR 1/2s Bolt Together



Inspected By		Date	REVISION 3/13
Item	QTY	Description	Size
①	2	Visor body Halve	13.5" x 32"
②	1	Outer Visor Brkt DS (VK 135004-5)	(factory installed)
③	1	Outer Visor Brkt PS (VK 135004-7)	(factory installed)
④	2	Center Visor Brkts(VK135004-2DS/-3PS)	1" x 11"
⑤	3	Cab Mounted Brkts (vk135004-6)	small
⑥	3	Internal Cab Support Plates	6" x 2 1/2"
⑦	44	Flat Washers	1/4 -20
⑧	10	Hex Head Bolts	1/4" x 20 x 3/4"
⑨	12	Hex Head Bolts	1/4" x 20 x 1"
⑩	22	Nylock nuts	1/4" x 20