



(A LIVERNE Company)

1200 E. Birch St.

Brandon, SD 57005

205840

**KENWORTH T680 / T-700**

**2011-CURRENT**

**INSTALLATION INSTRUCTIONS**

*READ THE INSTRUCTIONS COMPLETELY AND CHECK TO MAKE SURE THAT ALL OF THE REQUIRED PARTS ARE ON HAND BEFORE STARTING THE INSTALLATION.*

1. INSTALL THE MOUNTING BRACKET SPACERS (ITEM #8 **OR** #22), ONTO THE END OF THE BRACKET MOUNTING BARS (ITEM #4), THEN INSERT THE BRACKET MOUNTING BARS (ITEM #4), INTO THE TOW HOOK RECEIVERS ON THE TRUCK. YOU MUST USE THE VEHICLE SUPPLIED 1" DIA. PINS (OR EQUIVALENT) TO SECURE THE BRACKET MOUNTING BARS IN THE TOW HOOK RECEIVERS.
2. USING THE 5/8" X 7/8" SHOULDER BOLTS (ITEM #10), .630 X 1.25 X .040 X .082 BELLEVILLE WASHERS (ITEM #15) AND 1/2"-13 NYLOCK NUTS (ITEM #13), ATTACH THE MOUNTING BRACKETS (ITEM #2 & #3) TO THE OUTSIDE OF THE GUARD USING THE BOTTOM HOLES. TIGHTEN TO 65 FOOT POUNDS.
3. USING THE 5/16"-18 X 1-1/4" BUTTON HEAD SCREWS (ITEM #12), 5/16" FLAT WASHERS (ITEM #19), AND 5/16"-18 NYLOCK NUTS (ITEM #14), ATTACH THE RUBBER STOPS (ITEM #7) TO THE MOUNTING BRACKETS AS SHOWN IN FIG 1.
4. ASSEMBLE THE LATCHING HARDWARE (**SEE PAGE 4 FOR CONFIGURATION**) – LATCH BUSHING (ITEM #6), BELLEVILLE WASHERS (ITEM #15), 1" OD X 5/8" ID X 1/16" NYLON WASHERS (ITEM #16), MOUNTING BRACKET LATCH (ITEM #5), 1/2"-13 X 3" HEX HEAD BOLT (ITEM #11), 7/16" WASHER (ITEM # 18) AND 1/2"-13 HEX NYLOCK NUT (ITEM #13) TO THE MOUNTING BAR ON THE GRILLE GUARD. LEAVE LOOSE AT THIS TIME. (**NOTE: APPLY A SMALL AMOUNT OF GREASE TO THE SLOT AREA OF THE MOUNTING BRACKET LATCH TO AID IN SLIDING.**)
5. CLOSE THE MOUNTING BRACKETS ON THE LATCH BUSHINGS. CHECKING THAT THE RUBBERS ARE SEATED ON THE LATCH BUSHINGS AND TIGHTEN THE 1/2"-13 HEX BOLTS
6. OPEN UP THE BRACKETS AND WITH HELP, INSTALL THE GRILLE GUARD ASSEMBLY ONTO THE MOUNTING BRACKETS.



(A LIVERNE Company)

1200 E. Birch St.

Brandon, SD 57005

7. INSTALL THE 7/8"-9 X 3-1/2" BOLTS (ITEM #9) AND THE 7/8" LOCK WASHERS (ITEM #17) THROUGH THE FACE OF THE BRACKETS AND INTO THE MOUNTING BRACKET BARS (ITEM #4). TIGHTEN THE BOLT TO 150 FOOT POUNDS. (NOTE: WHEN TIGHTENING THE BOLTS THE BRACKETS WILL HAVE A TENDENCY TO ROTATE. TO KEEP THE BRACKET FROM ROTATING, INSERT A BAR IN THE TOW HOOK AND UNDER (RH) OR OVER (LH) THE SQUARE TUBE TO MAINTAIN A STRAIGHT UP AND DOWN POSITION.)

**NOTE: AFTER THE FIRST 1000 MILES, CHECK THE 7/8"-9 HEX MOUNTING BOLTS FOR LOOSENESS AND RETORQUE IF NECESSARY.**

**SERVICE PARTS LIST**

ITEM	PART NO.	QTY	DESCRIPTION
1	VARIES	1	GUARD – TUBULAR, 3"
2	206841	1	MOUNTING BRACKET – LH, ZP
3	206842	1	MOUNTING BRACKET – RH, ZP
4	205737	2	BRACKET MOUNTING BAR – ZP
5	205694	2	MOUNTING BRACKET LATCH – ZP
6	108972	2	LATCH BUSHING – ZP
7	205793	2	MOUNTING BRACKET STOP
8	205849	2	MOUNTING BRACKET SPACER
9	109505	2	SCREW – HEX HEAD, 7/8"-9 X 3-1/2", ZP
10	108968	2	BOLT – SHOULDER, 1/2" X 5/8"
11	109472	2	SCREW – HEX HEAD, 1/2"-13 X 3", ZP
12	108971	2	SCREW – BUTTON HEAD, 5/16"-18 X 1-1/4", SST
13	105654	4	NUT – NYLOCK, 1/2"-13, ZP
14	102380	2	NUT – NYLOCK, 5/16"-18, ZP
15	108969	10	WASHER – BELLEVILLE, .630 X 1.25 X .040 X .082
16	102149	2	WASHER – 1" OD X 5/8" ID X 1/16", HDPE
17	107874	2	WASHER – LOCK, 7/8", ZP
18	100081	2	WASHER – FLAT, 7/16", ZP
19	100034	2	WASHER – FLAT, 5/16", ZP
20	102500	4	TUBE INSERT – 3" (ON CERTAIN MODELS)
21	100252	1	SERIAL NUMBER DECAL
22	205697	2	MOUNTING BRACKET SPACER ('15+ KW T680)

REVISED 08MAR16 LVL C  
 REVISED 27OCT15 LVL B  
 REVISED 27AUG15 LVL A  
 PAGE 2 OF 4

SERVICE PARTS DRAWING

MODEL NO. - 205840

SEE SPACER  
NOTE IN  
UPPER RH  
CORNER

VEHICLE TOW HOOK PINS

USE THESE SPACERS  
FOR ALL PETE 579's  
& PRE-2015 KW  
T680 TRUCKS

USE THESE  
SPACERS FOR  
2015+ KW  
T680 TRUCKS

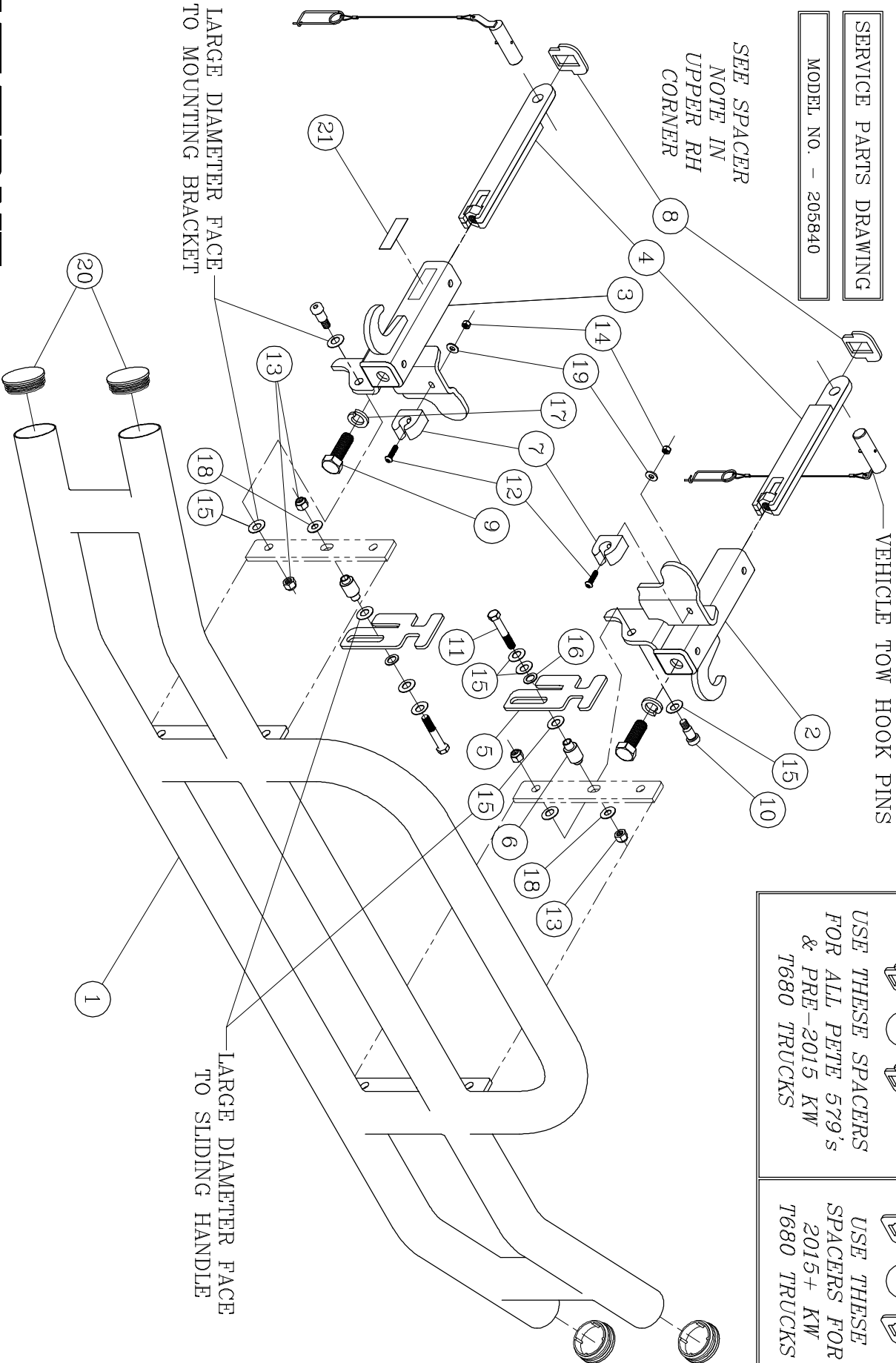

fig. 1

**LYVERNE**  
TRUCK TOW HOOK KIT

(A Lyverne Company)

1200 E. Birch St.

Brainerd, MN 57905

REVISED 08MARR16 LVL C  
REVISED 27OCT15 LVL B  
REVISED 27AUG15 LVL A  
205851 SHEET 3 OF 4 06FEB13



(A LOVERNE Company)

1200 E. Birch St. Brandon, SD 57005

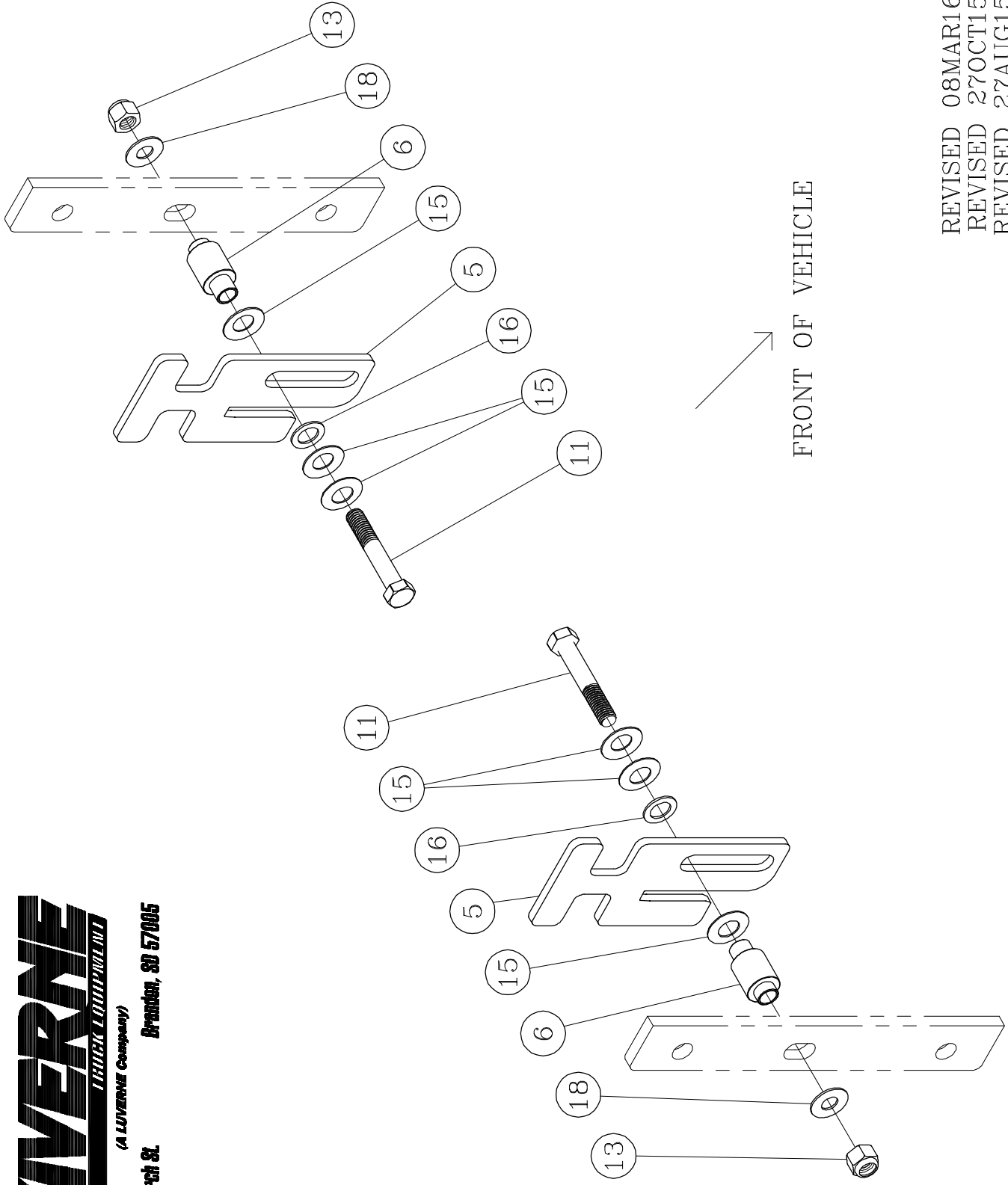

REVISED 08MAR16 LVL C  
REVISED 27OCT15 LVL B  
REVISED 27AUG15 LVL A  
205851 SHEET 4 OF 4 06FEB13