



(A LIVERNE Company)

1200 E. Birch St.

Brandon, SD 57005

205760

## FREIGHTLINER CASCADIA 2008-CURRENT

### INSTALLATION INSTRUCTIONS

READ THE INSTRUCTIONS COMPLETELY AND CHECK TO MAKE SURE THAT ALL OF THE REQUIRED PARTS ARE ON HAND BEFORE STARTING THE INSTALLATION.

1. INSERT THE BRACKET MOUNTING TUBES (ITEM #4), INTO THE TOW HOOK RECEIVERS ON THE TRUCK. AND INSTALL THE MOUNTING BRACKET SPACER (ITEM #16), 3/4" LOCK WASHER (ITEM #20) AND THE 3/4" X 2" HEX BOLT (ITEM #9) ON TO THE INSIDE END OF THE MOUNTING TUBES.
2. USING THE 5/8" X 7/8" SHOULDER BOLTS (ITEM #10), .630 X 1.25 X .040 X .082 BELLEVILLE WASHERS (ITEM #17) AND 1/2"-13 NYLOCK NUTS (ITEM #14), ATTACH THE MOUNTING BRACKETS (ITEM #2 & #3) TO THE OUTSIDE OF THE GUARD USING THE BOTTOM HOLES. TIGHTEN TO 65 FOOT POUNDS.
3. USING THE 5/16"-18 X 1-1/4" BUTTON HEAD SCREWS (ITEM #12), 5/16" FLAT WASHERS (ITEM #18) AND 5/16"-18 NYLOCK NUTS (ITEM #15), ATTACH THE RUBBER STOPS (ITEM #7) TO THE MOUNTING BRACKETS AS SHOWN IN *fig 1*.
4. ASSEMBLE THE LATCHING HARDWARE – LATCH BUSHING (ITEM #6), BELLEVILLE WASHERS (ITEM #17), 1" OD X 5/8" ID X 1/16" NYLON WASHERS (ITEM #19), MOUNTING BRACKET LATCH (ITEM #5), 1/2"-13 X 3" HEX HEAD BOLT (ITEM #11), 7/16" WASHER (ITEM #13) AND 1/2"-13 HEX NYLOCK NUT (ITEM #14) TO THE MOUNTING BAR ON THE GRILLE GUARD. TIGHTEN TO 65 FOOT POUNDS. (NOTE: APPLY A SMALL AMOUNT OF GREASE TO THE SLOT AREA OF THE MOUNTING BRACKET LATCH TO AID IN SLIDING.)
5. CLOSE THE MOUNTING BRACKETS ON THE LATCH BUSHINGS. CHECKING THAT THE RUBBERS ARE SEATING ON THE LATCH BUSHINGS.
6. OPEN UP THE BRACKETS AND WITH HELP, INSTALL THE GRILLE GUARD ASSEMBLY ONTO THE MOUNTING BRACKET BARS.
7. INSTALL THE 3/4"-10 X 3" BOLTS (ITEM #8) AND THE 3/4" LOCK WASHERS (ITEM #20) THROUGH THE FACE OF THE BRACKETS AND INTO THE MOUNTING BRACKET TUBES (ITEM #4). TIGHTEN THE BOLTS. (NOTE: WHEN TIGHTENING THE BOLTS THE BRACKETS WILL HAVE A TENDENCY TO ROTATE. TO KEEP THE BRACKET FROM ROTATING, HOLD THE BOTTOM OF THE MOUNTING BRACKET WITH CRESENT WRENCH.)
8. CLOSE THE GUARD ON THE RUBBERS, APPLYING PRESSURE TO COMPRESS THE RUBBER AND PUSH DOWN ON THE LATCH BRACKETS TO LOCK THE GUARD IN PLACE.

REVISED 27OCT15 LVL E  
REVISED 27AUG15 LVL D  
REVISED 05FEB13 LVL C  
REVISED 10OCT11 LVL B  
REVISED 31AUG10 LVL A  
PAGE 1 OF 3 23MAR09



(A LIVERNE Company)

1200 E. Birch St.

Brandon, SD 57005

**NOTE: AFTER THE FIRST 1000 MILES, CHECK THE 3/4"-10 HEX MOUNTING BOLTS FOR LOOSENESS AND RETORQUE IF NECESSARY.**

### SERVICE PARTS LIST

ITEM	PART NO.	QTY	DESCRIPTION
1	VARIES	1	GUARD – TUBULAR, 3”
2	206802	1	MOUNTING BRACKET – LH, ZP
3	206803	1	MOUNTING BRACKET – RH, ZP
4	205811	2	BRACKET MOUNTING BAR – ZP
5	205694	2	MOUNTING BRACKET LATCH – ZP
6	108972	2	LATCH BUSHING – ZP
7	205793	2	MOUNTING BRACKET STOP
8	108987	2	SCREW – HEX HEAD, 3/4”-10 X 3”, ZP
9	108989	2	SCREW – HEX HEAD, 3/4”-10 X 2”, ZP
10	108968	2	BOLT – SHOULDER, 5/8” X 7/8”
11	109472	2	SCREW – HEX HEAD, 1/2”-13 X 3”, ZP
12	108971	2	SCREW – HEX HEAD, 5/16”-18 X 1-1/4”, SST
13	100081	2	WASHER-FLAT, 7/16”, ZP
14	105654	4	NUT – NYLOCK, 1/2”-13, ZP
15	102380	2	NUT – NYLOCK, 5/16”-18, ZP
16	549495	2	MOUNTING BRACKET SPACER
17	108969	10	WASHER – BELLEVILLE, .630 X 1.25 X .040 X .082
18	100034	2	WASHER – FLAT, 5/16”, ZP
19	102149	2	WASHER – 1” OD X 5/8” ID X 1/16”, HDPE
20	101402	4	WASHER – LOCK, 3/4”, ZP
21	102500	4	TUBE INSERT – 3” (ON CERTAIN MODELS)
22	100252	1	SERIAL NUMBER DECAL

SERVICE PARTS DRAWING

MODEL NO. - 205760

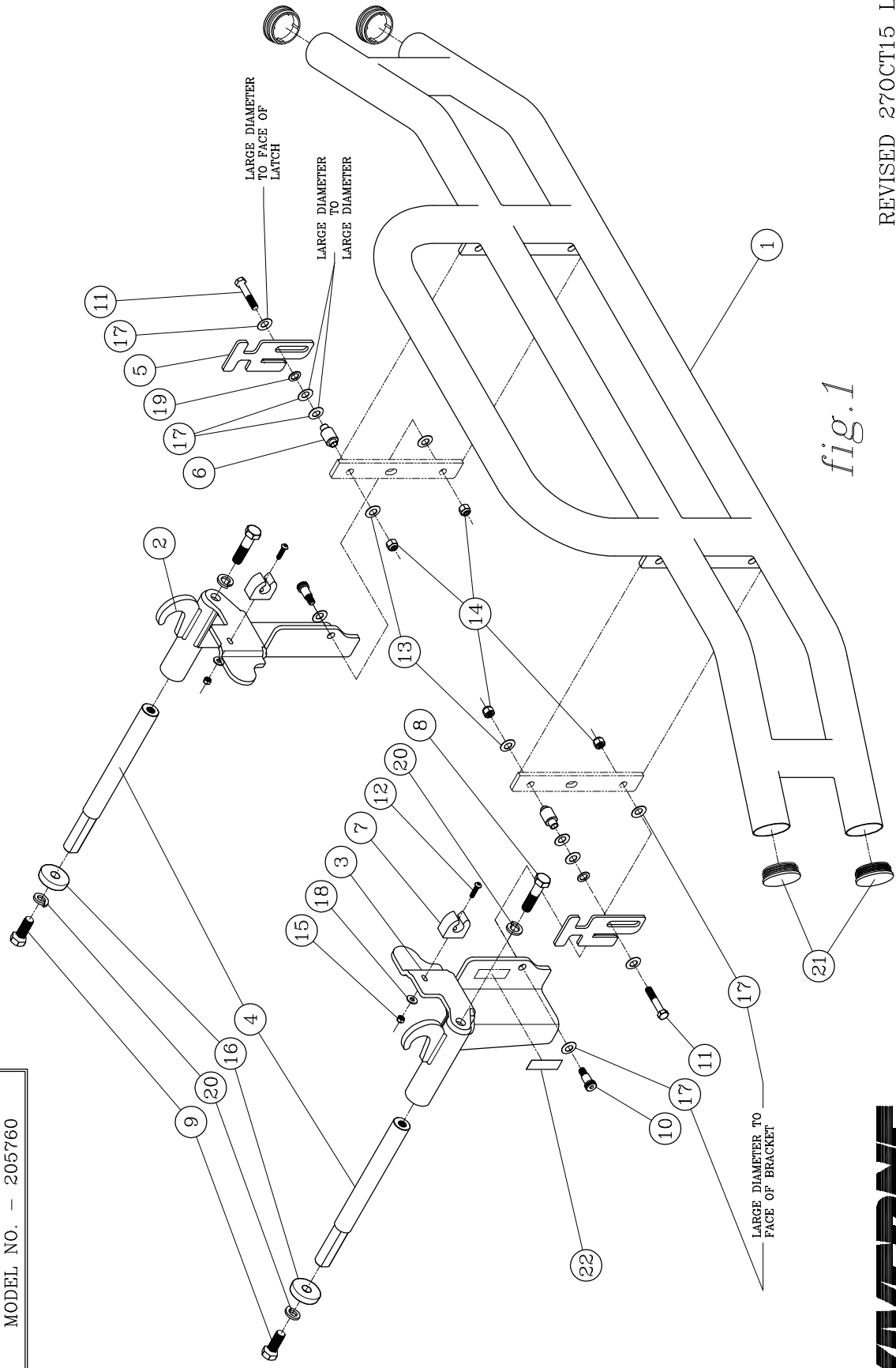

fig.1

REVISED 27OCT15 LVL E  
REVISED 27AUG15 LVL D  
REVISED 05FEB13 LVL C  
REVISED 10OCT11 LVL B  
REVISED 31AUG10 LVL A  
SHEET 3 OF 3 23MAR09

205762



1200 E. 4th St  
Brentwood, SD 57005