

CLASS 8 PETERBILT 379
(1987-CURRENT)

INSTALLATION INSTRUCTIONS

READ THE INSTRUCTIONS COMPLETELY AND CHECK TO MAKE SURE THAT ALL OF THE REQUIRED PARTS ARE ON HAND BEFORE STARTING THE INSTALLATION.

1. LOOSEN AND REMOVE THE FOUR OUTER MOST BOLTS FROM THE FACTORY BUMPER.
2. INSTALL THE MOUNTING BRACKETS (ITEMS #3 & #4), USING THE 1/2-13 X 2" HEX BOLTS (ITEM #11), 1/2" FLAT WASHERS (ITEM #13), AND 1/2-13 SERRATED FLANGE NUTS (ITEM #6) AS SHOWN IN FIG. 1. HAND TIGHTEN ONLY AT THIS TIME, TO BE ADJUSTED LATER.
3. INSTALL THE GUARD (ITEM #1) ONTO THE MOUNTING BRACKETS AND FASTEN WITH 5/8-11 X 2" HEX BOLTS (ITEM #12), 9/16" FLAT WASHERS (ITEM #14), 5/8" NYLON WASHERS (ITEM #15) AND 5/8-11 NYLOCK NUTS (ITEM #7).
4. SECURE THE TOP OF THE GUARD TO THE TOP OF THE MOUNTING BRACKETS WITH THE CLEVIS PINS (ITEM #8) AND THE HAIR PINS (ITEM #9)
5. SNUG UP THE 5/8-11 NYLOCK NUTS SO THAT THE GUARD IS SNUG BUT WILL STILL ROTATE EASILY WHEN LOWERING THE GUARD TO OPEN THE HOOD. CHECK THAT THE GUARD IS CENTERED ON THE BUMPER AND THE MOUNTING BRACKETS ARE STRAIGHT UP AND DOWN. THEN TIGHTEN THE FOUR 1/2-13 X 2" HEX BOLTS SECURING THE MOUNTING BRACKETS TO THE BUMPER. TIGHTEN TO 75 FOOT-POUNDS OF TORQUE.
6. INSTALL THE 1/2-13 X 1" HEX BOLTS (ITEM #10) AND THE 1/2-13 NYLOCK NUTS (ITEM #5) THAT ARE USED AS STOPS WHEN LOWERING THE GUARD. ALIGN A FLAT SIDE OF THE BOLT HEAD WITH THE FLAT SURFACE OF THE MOUNTING TAB ON THE GUARD AND TIGHTEN THE NUT.
8. *(OPTIONAL STEP)* THE LOWER HOLE ON EACH MOUNTING BRACKET IS AN OPTIONAL DRILL HOLE THROUGH THE BUMPER. THE GUARD WILL FUNCTION FINE WITHOUT DRILLING, BUT WILL BE STRONGER IF DRILLED AND ATTACHED TO THE LOWER PORTION OF THE BUMPER.

CLASS 8 PETERBILT 379
(1987-CURRENT)

SERVICE PARTS LIST

| ITEM | PART NO. | QTY | DESCRIPTION |
|------|----------|-----|--------------------------------------|
| 1 | 205500 | 1 | GUARD – TUBULAR, 3” SST |
| | 205501 | | GUARD – TUBULAR, 3” BLACK |
| 2 | 102500 | 4 | INSERT – FINISH, BLACK, 3” |
| 3 | 205522 | 1 | MOUNTING BRACKET – LH, ZP |
| 4 | 205524 | 1 | MOUNTING BRACKET – RH, ZP |
| 5 | 105654 | 2 | NUT – NYLOCK, 1/2-13, ZP |
| 6 | 100123 | 6 | NUT – SERRATED FLANGE, 1/2-13, ZP |
| 7 | 107435 | 2 | NUT – NYLOCK, 5/8-11, ZP |
| 8 | 107438 | 2 | PIN – CLEVIS, 5/8 X 2 |
| 9 | 100159 | 2 | PIN – HAIR , 9GA., ZP |
| 10 | 100085 | 2 | SCREW – HEX HEAD, 1/2-13 X 1, ZP |
| 11 | 100091 | 6 | SCREW – HEX HEAD, 1/2-13 X 2, ZP |
| 12 | 100144 | 2 | SCREW – HEX HEAD, 5/8-12 X 2, ZP |
| 13 | 104995 | 6 | WASHER – FLAT, 1/2, SAE, SST |
| 14 | 100140 | 4 | WASHER – FLAT, 9/16, USS, ZP |
| 15 | 102149 | 4 | WASHER – NYLON, 1 OD X 5/8 ID X 1/32 |

SERVICE PARTS DRAWING

MODEL NO. - 205520

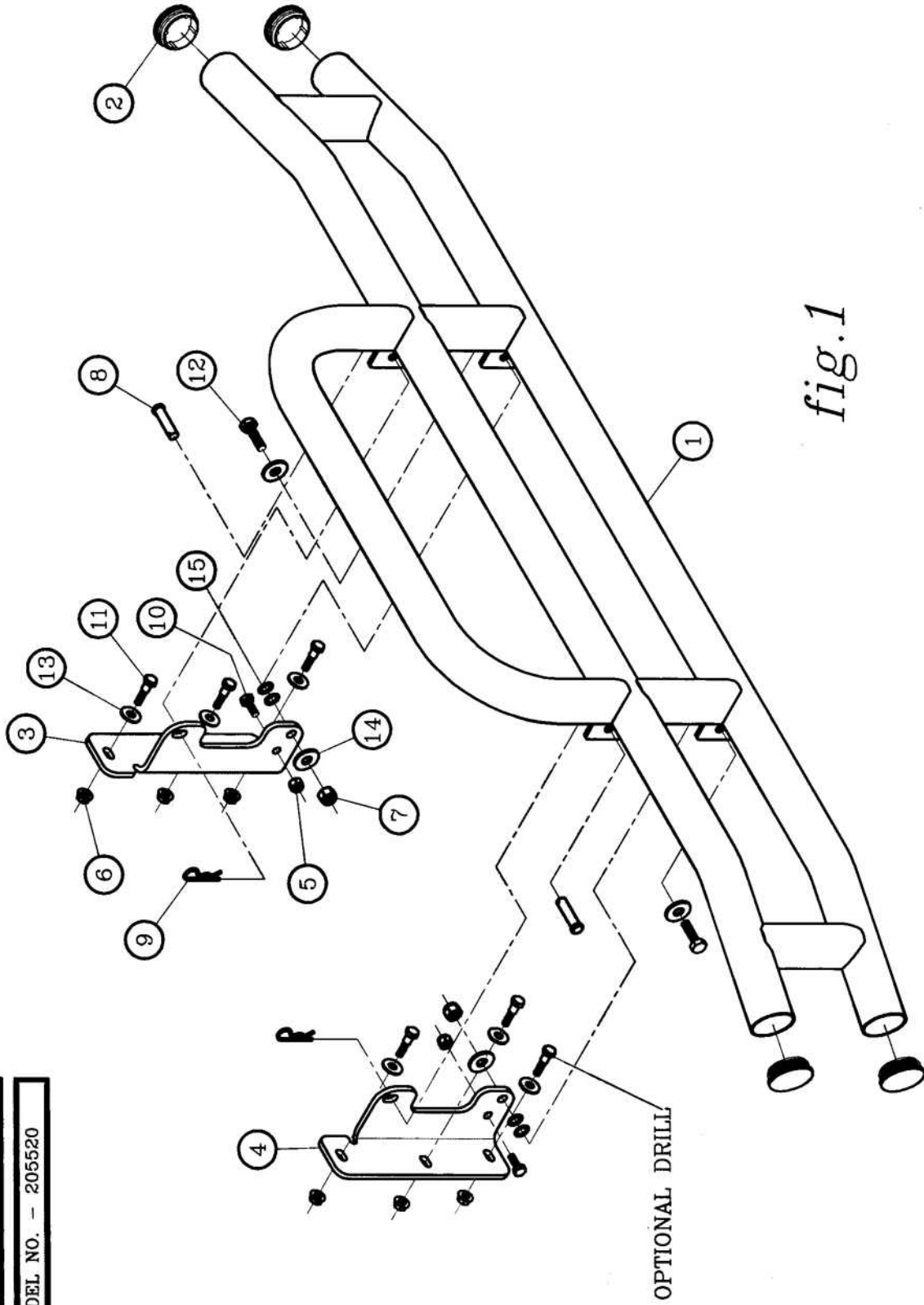

fig.1

LIVERNE
ISO9001 CERTIFIED
1200 Birch Street
Brandon, SD 57005