

| | | | | | | | |
|----------|----|------|------------|-------------|--|----------|-------|
| DRAWN | DL | DATE | 06/22/2017 | DESCRIPTION | NEW RELEASE WITH REVISED BRACKETS AND WIRING | NPI # | 01474 |
| APPROVED | GG | DATE | 07/07/2017 | | | REVISION | - |
| DRAWN | SD | DATE | 08/17/2017 | DESCRIPTION | ADD ITEM 10; REDUCED ITEM 4 QTY. | ECN # | 00522 |
| APPROVED | DL | DATE | 08/17/2017 | | | REVISION | -.01 |

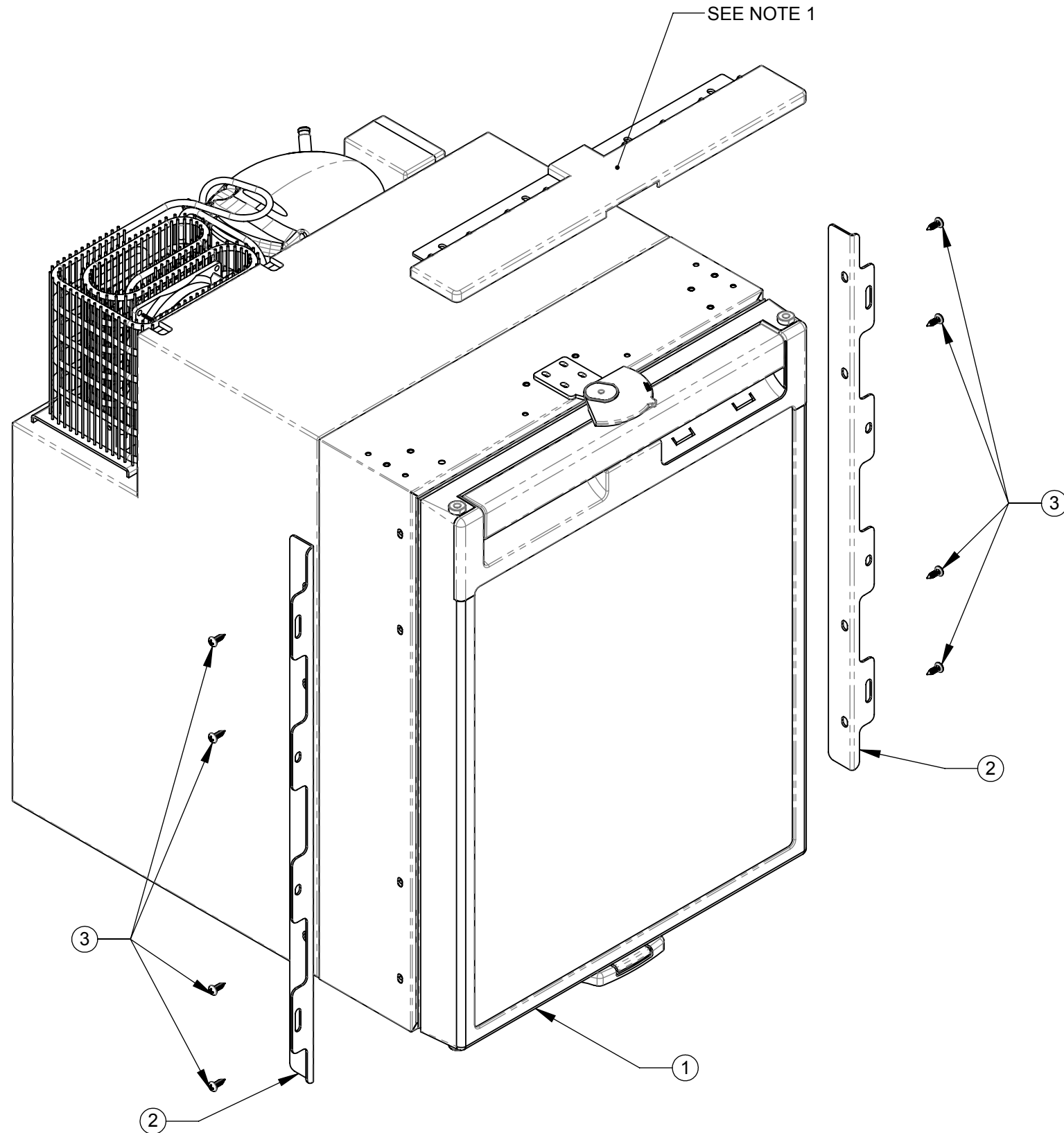

1. REMOVE AND DISCARD TOP TRIM.
2. ATTACH BRACKETS TO SIDES OF REFRIGERATOR USING SHEET METAL SCREWS.
3. INSERT REFRIGERATOR WIRES (NOT SHOWN) THROUGH 15324985 SEALS; TERMINATE WITH 12048159 TERMINALS; INSERT INTO 15300002 CONNECTOR; ASSEMBLE 15300014 TPA LOCK.
4. INSERT AGC10 INTO 90-617-6 (NOT SHOWN); INSERT WIRES THROUGH 15324980 SEALS; TERMINATE CORD WITH 12066214 TERMINALS; INSERT INTO 15300008 CONNECTOR; ASSEMBLE 15300014 TPA LOCK.

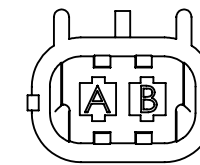

MATING VIEW OF
15300002 CONNECTOR
A=BLACK (GROUND)
B=RED (12V DC)

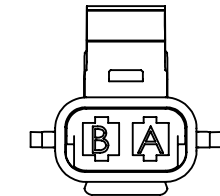

MATING VIEW OF
15300008 CONNECTOR
A=GROUND TABS
B=CENTER CONTACT

| ITEM | PART# | DESCRIPTION | QTY | UOM |
|------|-----------|--|-----|-----|
| 1 | CD-50 | REFRIGERATOR,FREEZER, DRAWER, BLK, DC ONLY | 1 | EA |
| 2 | PP607028 | FRAME, CRX/CD-50, T680/T880 (L&R PAIR) | 1 | EA |
| 3 | 8N50TXP0Z | PHPSMS, #8 X.50 | 8 | EA |
| 4 | 15324985 | SEAL, PURPLE INDIVIDUAL CABLE 1W M/P | 2 | EA |
| 5 | 12048159 | TERMINAL, MALE | 2 | EA |
| 6 | 15320002 | 2-WAY BLK CONNECTOR (MALE) | 1 | EA |
| 7 | 15300014 | TPA LOCK BLUE | 2 | EA |
| 8 | 90-617-6 | CALRAD CIGARETTE LIGHTER PLUG WITH 20 AMP FUSE | 1 | EA |
| 9 | AGC10 | 10A AGC FUSE | 1 | EA |
| 10 | 15324980 | SEAL, GRAY INDIVIDUAL CABLE 1W M/P | 2 | EA |
| 11 | 12066214 | TERMINAL, FEMALE | 2 | EA |
| 12 | 15300008 | 2-WAY BLK CONNECTOR (FEMALE) | 1 | EA |

| | | | | |
|---|----------|------------|-------------------------------|--|
| PANA-PACIFIC A DIVISION OF THE BRIX GROUP, INC. THIS DRAWING AND THE INFORMATION IN IT ARE PROPRIETARY TO PANA-PACIFIC AND CANNOT WITHOUT PRIOR PERMISSION BE REPRODUCED, COPIED, OR DISCLOSED IN ANY MANNER | DRAWN | DL | MATL | ALL DIMENSIONS IN MILLIMETERS (INCHES) TOLERANCE UNLESS OTHERWISE SPECIFIED: X, X.X = ±1.5 (.06) XX = ±0.80 (.03) XXX = ±0.250 (.010) INTERPRET PER ANSI Y14.5 - 2004 |
| | DATE | 06/22/2017 | FINISH | |
| | APPROVED | GG | PKG | |
| | DATE | 07/07/2017 | LABEL | |
| DESCRIPTION | | | KIT, REFRIG, CD-50, T680/T880 | |
| DRAWING/PART NUMBER | | | PP607051 | |
| | | | SHEET 1 OF 1 | |